

Semirigid Ureteroscopes

Premium Instruments for Efficient and Convenient Stone Management

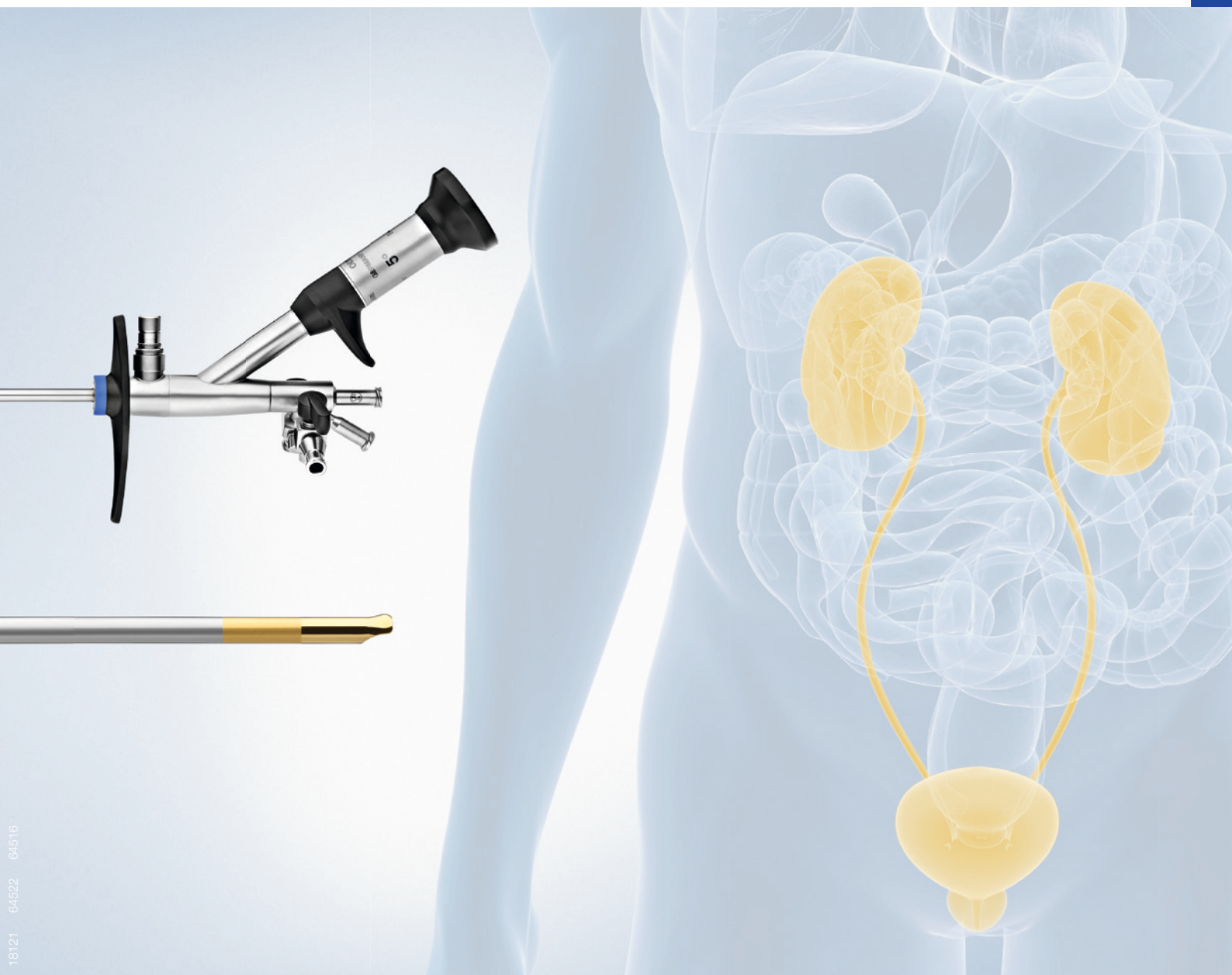

OES Elite Semirigid Ureteroscopes

Full HD-Compatibility, Super Slim Atraumatic Tip and Ergonomic Handle to Fully Meet Procedural Requirements

The OES Elite ureteroscope built with up to 50,000 fibers and a moiré filter delivers an excellent HD-system-compatible image. Equipped with an atraumatic tip design and an ergonomic handle, Olympus provides a full OES Elite portfolio with single- and dual-channel ureteroscopes to fully meet procedural requirements and urologists' preferences.

Moiré Filter

High image quality thanks to the built-in moiré filter. The large fiber bundle enables high resolution and an increased image size of the dual-channel ureteroscope.

Ergonomic Handle

Ensures secure and comfortable handling during ureteroscopies.

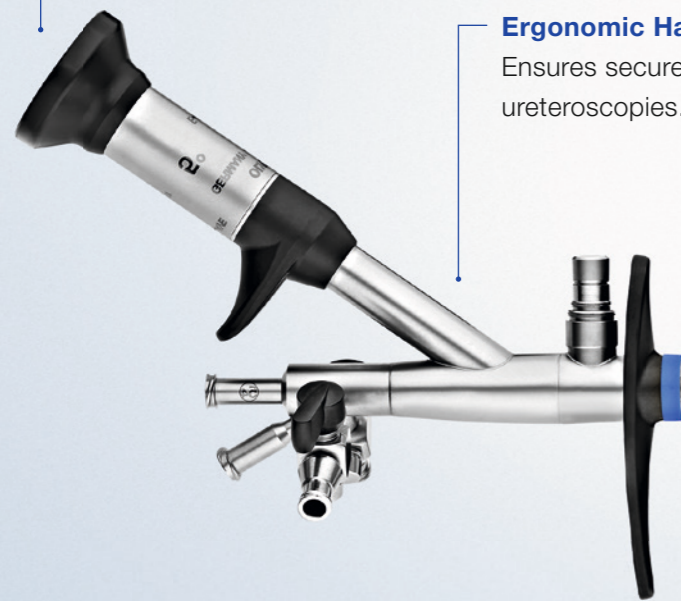

Antireflection Tip Design

The antireflection tip design prevents internal reflections when putting an object right in front of the optical system.

Super Slim Atraumatic Tip

The complete OES Elite portfolio ensures minimal invasiveness and facilitates the insertion into the ostium.

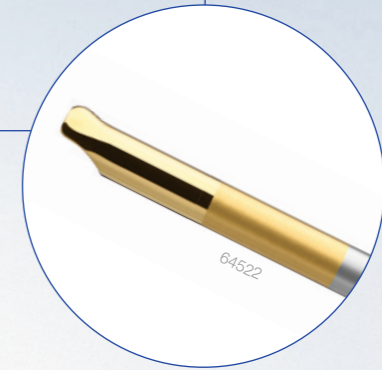

Full Portfolio Available

Working channel of 4.2 Fr and up to 6.4 Fr. The OES Elite is available as single-channel and dual-channel instruments.

Special Outer Tube Material

The material deforms less while adjusting to the patient's anatomy to ensure an atraumatic procedure. Due to greater resistance to permanent bending, the OES Elite ureteroscope will remain straight after the procedure.



Improved Visualization

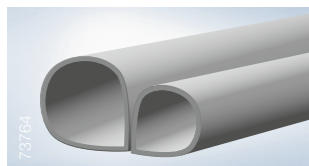

Dual-Channel Redesign

Due to the new channel geometry of the dual-channel ureteroscope, an optimal flow is ensured even with working inserts introduced at the same time.



Different Ocular Options

For urologists' individual preferences.

Reprocessing

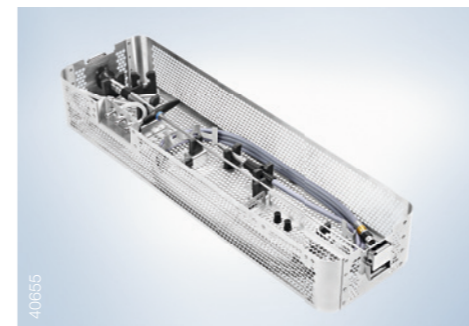

Instrument Tray

The metal reprocessing tray available for OES Elite ureteroscopes is compatible with automated washers, disinfectors and standard sterilization. The tray comes with an additional compartment for small pieces and has an extra space for bar code tracking.

OES Elite Semirigid Ureteroscopes

 www.olympus.eu/medical

Specifications, design and accessories are subject to change without any notice or obligation on the part of the manufacturer.

OLYMPUS

OLYMPUS EUROPA SE & CO. KG
Postbox 10 49 08, 20034 Hamburg, Germany
Wendenstrasse 14-18, 20097 Hamburg, Germany
Phone: +49 40 23773-0, Fax: +49 40 233765
www.olympus-europa.com